

THIS DRAWING IS UNPUBLISHED. RELEASED FOR PUBLICATION ,19 .
 © COPYRIGHT 19 BY AMP INCORPORATED. ALL RIGHTS RESERVED.

LOC	DIST	REVISIONS			
P	LTR	DESCRIPTION	DATE	DWN	APVD
G	14	M	REVISED PER 0720-0939-96	24MAY96	DKS DMS

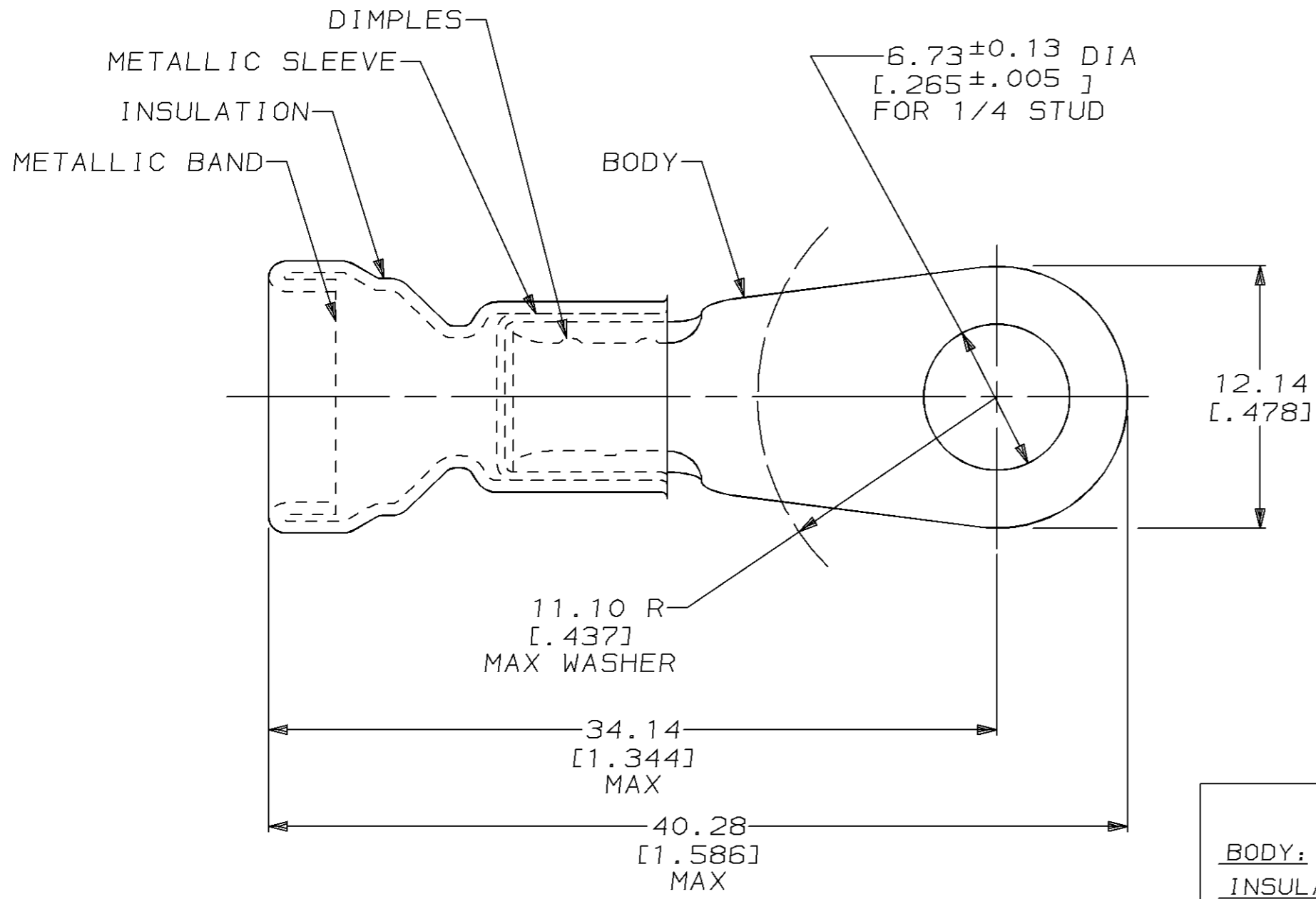

- 1 MATERIAL THK: 1.02 ± 0.08 [.040 ± .003]
- 2 WIRE INSULATION DIA: 7.57 [.298] MAX
- 3 TIN PL 0.00254 [.000100] MIN THK PER MIL-T-10727
- 4 GOLD PL 0.00127 [.000050] MIN THK PER MIL-G-45204 OVER NICKEL PL 0.00076 [.000030] MIN THK PER QQ-N-290
- 5 INSULATION COLOR: RED
- 6 INSULATION COLOR: YELLOW
- 7 TAPE MOUNTED PER 115-11001

BODY: COPPER PER ASTM B-152 INSULATION: PVC METALLIC SLEEVE: COPPER PER ASTM B-152 METALLIC BAND: STEEL PER ASTM A-109	Δ 2-322049-5 Δ 5
	Δ 2-322049-3 Δ 6 OBSOLETE
	Δ 2-322049-1 Δ 5 OBSOLETE
	Δ 322049 Δ 5
MATERIAL & FINISH	
AMP PART NUMBER	

AMP INCORPORATED
CUSTOMER SERVICE SYSTEMS

FOR ADDITIONAL PRODUCT INFORMATION OR COPIES OF DRAWINGS AND TECHNICAL DOCUMENTS	PRODUCT INFORMATION CENTER 1-800-522-6752	RECOMMENDED OPERATING TEMPERATURE: 105°C MAX
FOR APPLICATION TOOLING INFORMATION	TOOLING ASSISTANCE CENTER 1-800-722-1111	VOLTAGE RATING: NOT APPLICABLE
FOR ORDER ENTRY	1-800-526-5142	WIRE CROSS SECTIONAL AREA RANGE: SOLID OR STRANDED

THIS DRAWING IS A CONTROLLED DOCUMENT FOR AMP INCORPORATED. IT IS SUBJECT TO CHANGE AND THE CONTROLLING ENGINEERING ORGANIZATION SHOULD BE CONTACTED FOR THE LATEST REVISION.

DIMENSIONS: mm [INCHES]	TOLERANCES UNLESS OTHERWISE SPECIFIED:
	0 PLC ±-
	1 PLC ±-
	2 PLC ±0.20 [.008]
	3 PLC ±-
	4 PLC ±-
	ANGLES ±-
MATERIAL SEE TABLE	FINISH SEE TABLE

DWN DK SCHRUM 10MAY96	AMP AMP Incorporated Harrisburg, PA 17105-3608
CHK DM SWARTZ 13MAY96	
APVD JL MECKLEY 13MAY96	
PRODUCT SPEC -	NAME TERMINAL, RING TONGUE, AMPLI-BOND™, WIRE SIZE: 8 AWG
APPLICATION SPEC -	SIZE A3
WEIGHT -	CAGE CODE 00779
CUSTOMER DRAWING	DRAWING NO C-322049
	SCALE 4:1
	SHEET 1 OF 1
	REV M