

REV.	DATE	ECR NO.	DESCRIPTION
NC	08/30/04	-	INITIAL RELEASE
A	04/20/08	100006	CHANGED MCX SIDE INTO STANDARD MCX JACK.

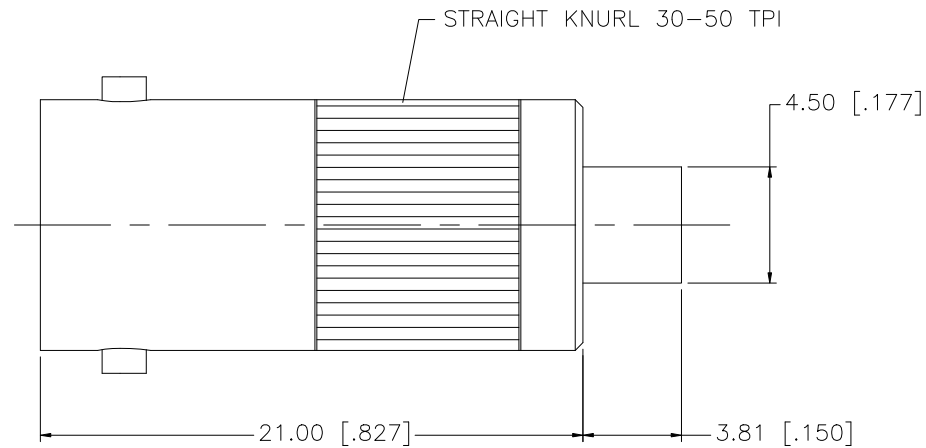

REV.	DATE	ECR NO.	DESCRIPTION
8			
7			
6			
5			
4			
3			
2			
1			
DESCRIPTION	MATERIAL	FINISH	QTY

UNLESS OTHERWISE SPECIFIED DIMENSIONS ARE IN MILLIMETERS. DIMENSIONS IN [ ] ARE IN INCHES AND FOR CUSTOMER REFERENCE ONLY.				APPROVALS	DATE	<h1 style="text-align: center; color: blue;">Amphenol Connex</h1>		
UNLESS OTHERWISE SPECIFIED TOLERANCES FOR MILLIMETERS ARE: 0.5 - 8mm ± 0.20mm 8 - 30mm ± 0.40mm 30 - 120mm ± 0.50mm				DRAWN GRS	04/20/08			
UNLESS OTHERWISE SPECIFIED TOLERANCES FOR INCHES ARE: .020 - .315 = ± 0.007" .315 - 1.180 = ± 0.015" 1.180 - 4.724 = ± 0.020"				CHECKED				
DO NOT SCALE DRAWING				ISSUED				
				SHEET 1 OF 1				
PART DESCRIPTION								
BNC JACK TO MCX JACK ADAPTER								
PART NO. 242206								
				DWG. NO.	242206.DWG	REV. A	SIZE A	SCALE NA